

The  
University of  
Wisconsin -  
*Eau Claire*

NFA  
Tournament Book  
*46th edition*



# Welcome to Our Home

Dear NFA Competitors,

Welcome to the University of Wisconsin-Eau Claire, nestled right in the Chippewa Valley, surrounded by rolling hills and the beautiful Chippewa River. We hope you enjoy your stay here and have a chance to appreciate the beauty that this part of the country has to offer.

The students of CJ351 have been working all semester to make this an event to remember. We have chosen "Home is NFA" as the theme this year, and have incorporated it in all aspects of the competition. We hope that you truly feel that you're home this year at NFA, and embrace "home" here in Eau Claire with your fellow competitors.

We wish you luck throughout the competition, and we'll be here cheering you on. We will also be available throughout the tournament if you find that you run into challenges, or simply cannot find your room. Feel free to reach out to us if you have questions.

Sincerely,  
The students of CJ 351



*Recipe: For Success*

*Ingredients:*

- 1 teaspoon of ideas*
- ½ cup of goodwill*
- 1 pinch of positivity*
- ¾ cup of imagination*
- 1 lb of leadership*
- 2 spoonfuls of teamwork*
- 1 cup of confidence*
- 3 tablespoons of patience*
- And 1 bag of hope*

*Serves: One Team From: UW-Eau Claire*



[www.nfa2017.com](http://www.nfa2017.com)



@ National Forensic Association



@ nfa\_2017



@ NFA2017



@ NFAForensics

# Table of Contents

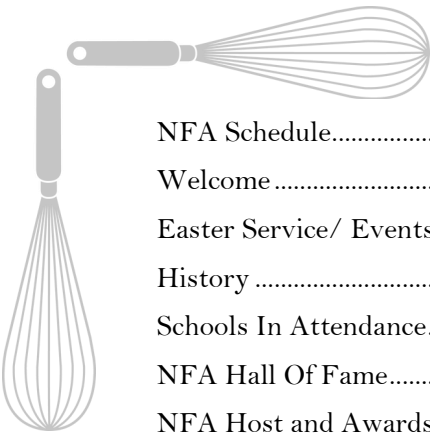

NFA Schedule.....	Pg. 3
Welcome .....	Pg.4-8
Easter Service/ Events.....	Pg. 9
History .....	Pg. 10
Schools In Attendance.....	Pg. 11
NFA Hall Of Fame.....	Pg. 12
NFA Host and Awards.....	Pg. 13
Team Champions and Pentathlon Champions.....	Pg. 14
Tournament History.....	Pg. 15-19
Welcome to Our Home—Local Information.....	Pg. 20
Davies Center Dining/Acknowledgments.....	Pg. 21
Campus Map/Davies Center Map.....	Pg. 22- 23

## 2017 NFA Schedule

### Wednesday, April 12

7:00 p.m. - 9:00 p.m. Early Registration-Clarion  
Northwoods Room

### Thursday, April 13

9:00 a.m. - 10:45 a.m. Registration-1st Floor Davies  
11:30 a.m. - 12:15 p.m. Opening Assembly — Zorn  
12:30 p.m. - 1:45 p.m. Round 1 LD  
1:45 p.m. - 3:00 p.m. Round 2 LD  
3:00 p.m. - 3:30 p.m. Extemp Draw — Ojibwe C  
3:30 p.m. - 4:45 p.m. Round 1A (EXT, PRO)  
4:45 p.m. - 6:15 p.m. Round 1B (ADS, DI, RC)  
6:15 p.m. - 7:45 p.m. Round 2B (ADS, DI, RC)

### Friday, April 14

8:00 a.m. - 10:00 a.m. Student Meeting-Zorn  
Coaches Meeting-Schofield  
10:15 a.m. - 11:30 a.m. Round 3 LD  
11:30 a.m. - 12:45 p.m. Round 4 LD  
12:45 p.m. - 1:15 p.m. Extemp Draw — Ojibwe C  
1:15 p.m. - 2:30 p.m. Round 2A (EXT, PRO)  
2:30 p.m. - 4:00 p.m. Round 3B (ADS, DI, RC)  
4:00 p.m. - 5:30 p.m. Round 1C (INF, PER, POE)  
5:30 p.m. - 7:00 p.m. Round 1D (DUO, IMP)

### Saturday, April 15

8:00 a.m. - 8:30 a.m. Extemp Draw — Ojibwe C  
8:30 a.m. - 9:45 a.m. Round 3A (EXT, PRO)  
9:45 a.m. - 11:00 a.m. Round 2C (INF, PER, POE)  
11:00 a.m. - 12:15 p.m. Round 5 LD  
12:30 p.m. - 1:45 p.m. Round 2D (DUO, IMP)  
1:00 p.m. - 2:15 p.m. LD Open Forum —  
Dakota Ballroom  
2:15 p.m. - 3:45 p.m. Round 3C (INF, PER, POE)  
3:45 p.m. - 5:00 p.m. Round 3D (DUO, IMP)  
5:00 p.m. - 5:30 p.m. Extemp Draw — Ojibwe C  
5:30 p.m. - 7:00 p.m. Octafinals A and Novice A  
7:00 p.m. - 8:30 p.m. Round 6 LD

### Sunday, April 16 (Easter)

7:00 a.m. - 7:45 a.m. Non-Denominational Easter  
Service (Clarion Inn)  
8:00 a.m. Double Octo-Finals LD  
9:15 a.m. - 10:45 a.m. Octafinals B and Novice B  
10:45 a.m. -12:15 p.m. Octafinals C and Novice C  
1:00 p.m. - 2:30 p.m. Octafinals D/LD  
and Novice LD/D  
2:45 p.m. - 3:15 p.m. Extemp Draw — Ojibwe C  
3:15 p.m. - 4:45 p.m. Quarterfinals, A/B  
4:45 p.m. - 6:15 p.m. Quarterfinals C/D/LD

### Monday, April 17

7:30 a.m. - 8:00 a.m. Extemp Draw — Ojibwe C  
8:00 a.m. - 10:00 a.m. Semifinals, A/B  
10:00 a.m. - 12:00 p.m. Semifinals, C/D/LD  
12:00 p.m. - 12:30 p.m. Extemp Draw — Ojibwe C  
12:30 p.m. - 2:00 p.m. Finals, A/B  
2:30 p.m. - 4:00 p.m. Finals, C/D/LD  
6:00 p.m. Awards — Zorn Arena

### Event Patterns

A: Extemp, Prose  
B: After Dinner, Dramatic Interp, Rhetorical Criticism  
C: Persuasion, Poetry, Informative  
D: Duo, Impromptu

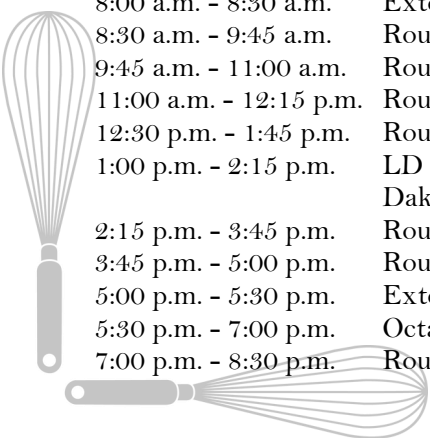



## University of Wisconsin-Eau Claire

105 Garfield Avenue • P.O. Box 4004 • Eau Claire, WI 54702-4004

April 13, 2017

Dear NFA Participants,

On behalf of our more than 10,500 students and 1,200 faculty and staff, welcome to the University of Wisconsin-Eau Claire. This is a special year for our university as we are celebrating our Centennial. We also are celebrating 100 years of forensics — a program that has long been emblematic of our credo "Excellence." Many Blugolds have earned top honors in state, regional and national forensics competitions.

This is the second time UW-Eau Claire has hosted the NFA National Tournament, and we have been proud participants in the tournament for all but the first two years of its existence. I want to extend special thanks to Director of Forensics Karen Morris, this year's NFA President, her students, and the Department of Communications and Journalism for helping to organize and host this premiere event.

You represent the best of the best among collegiate communicators and I salute you for the hard work, long hours and dedication that have led you to this competition.

While I know you will be very busy competing, I hope you are able to enjoy the beauty of our campus (please pardon our construction) and sample some of what our greater Eau Claire community has to offer. Nearby downtown Eau Claire has a variety of stores, restaurants and coffee shops, including live music venues. Phoenix Park, along the banks of the Chippewa River, offers walking trails as well as places to relax and reflect.

We are a campus and community known for its friendliness — so if you have questions about where to eat or find a particular store, service or activity, please don't hesitate to ask. The theme of your tournament this year is "Home is NFA," and it is our sincere desire to make you feel at home while you are here.

Best wishes to all teams for a successful and satisfying tournament.

Sincerely,



James C. Schmidt

Chancellor

Excellence. Our measure, our motto, our goal.

Office of the Chancellor Schofield 204 • (715) 836-2327 • fax: (715) 836-2902





## University of Wisconsin-Eau Claire

105 Garfield Avenue • P.O. Box 4004 • Eau Claire, WI 54702-4004

April 13, 2017

Dear NFA Family,

Home is where the heart is and my heart has always been with NFA. NFA to me has always meant "family". NFA has always been the Nationals where every team member could contribute to the team's success. NFA is the tournament where you have to live and breathe and eat with your team for five long days and still love them. NFA has always been the National Tournament where the novice competitor gets hooked on forensics and decides to come back next year when just a month before they were thinking about ending this season and saying goodbye to an activity they didn't think was for them. NFA is the Nationals where you cheer just as loudly for individuals as you do for teams. NFA is the Nationals where you hear the thunderous double clap for all Quarter-finalist, Semi-finalist and now Octafinalists. NFA is the Nationals where good things happen to good people. NFA is the National Tournament that brings the world of LD and I.E. together for five glorious days. NFA is the only National Tournament that I would host twice. It is the only National Tournament I would host while the UWEC campus is in full swing. I cannot wait for my UWEC family to meet my NFA family.

I am thrilled that you have come to NFA this year. If this is your first NFA, I hope you will discover that familiar feeling of NFA. If this is your second NFA, I wish you all of the good fortune, competition, bonding, learning and growth that this National Tournament has to offer. If this is your third NFA, enjoy it, as it will be gone before you know it. If this is your fourth NFA, then you really are family and once NFA, then always NFA. Make a memory in your last year as a competitor and start to make plans now about how you can continue your journey and relationship with NFA as a judge, coach, committee member, officer or even host.

And so no matter if you are a competitor, a judge, a UWEC Alumni, a faculty member or a supportive parent, welcome home to NFA. Go ahead and take off your coat; stay for a day (or five).

So glad you are here,



Karen Morris  
NFA President  
UWEC Director of Forensics  
2017 NFA Tournament Host

Excellence. Our measure, our motto, our goal.  
UWEC Forensics • HHH 175 • 715-836-3305 • .fax: 715-836-3820  
[www.uwec.edu/4N6/](http://www.uwec.edu/4N6/) • Karen Morris, Director • [morriskr@uwec.edu](mailto:morriskr@uwec.edu)

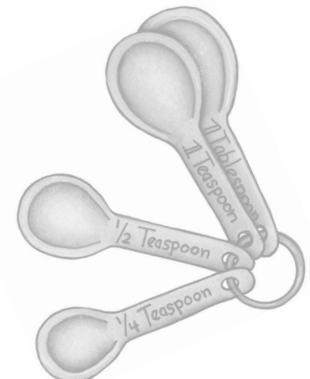

# Welcome to Our Home

LARRY SCHNOOR  
107 Agency Road  
Mankato, MN 56001

April 13, 2017

National Forensic Association  
University of Wisconsin, Eau Claire  
National Tournament Participants

It gives me great pleasure to be able to greet all of you that are attending this National Championship Tournament. If I am not mistaken, this is the second time that NFA has been hosted by UWEC. I know that Director of Forensics Karen Morris and her Assistant Director, Kelly Jo Wright, have worked hard for several months to make sure you will all have a good experience – what some may call a “Friendly Wisconsin Welcome.”

As your Past President I am glad that I can still be part of this outstanding Association. During the years, which are many, that I have been involved with the activities and work of the NFA, I have been able to form many strong relationships with so many involved with NFA. I hold in my heart very special memories with not only the coaches and directors of forensic programs around the nation, but also with hundreds of students that have competed in this event.

What you are experiencing here is possible because there have been many individuals that have served this organization to make it one that showcases outstanding performances of students across the nation. There are so many dedicated forensics educators that have given service to NFA. Eddie Myers is the first that comes to my mind – he was an outstanding coach and also served as the Tournament Director for a number of years. Another individual is Vicki Karns, who was very involved in the early years along with Ed Harris, Christine Reynolds, and even the founder of NFA, Seth Hawkins and many more over the years. A few of those people are here attending, and I know they would enjoy hearing from all of you when the opportunity presents itself during the tournament.

As your Past President I am extremely pleased to continue to be involved in working with all of the individuals on the National Council. The Council has worked and is working to make sure this Organization continues to grow and be of service to the Forensic Community. Enjoy the next several days, and when you can, remember to thank your coaches and any others that you feel have contributed to your growth in the understanding and delivery of effective community skills.

Yours Truly,

Larry Schnoor  
Past President NFA  
Emeritus Professor, MN State University, Mankato





## University of Wisconsin - Eau Claire

---

105 Garfield Avenue • P.O. Box 4004 • Eau Claire, WI 54702-4004

April 13, 2017

Dear NFA Participants,

As a proud alumnus of the University of Wisconsin-Eau Claire Forensics program, please accept my warm welcome to the 2017 NFA Tournament.

Competing in college forensics was one of my fondest and most formative experiences. Through forensics I, like many of you, learned how to hone my skills as a communicator; forged strong personal bonds (I met my wife!) that have lasted many years; and developed an understanding that while winning isn't everything – it sure can be satisfying!

One of the great benefits of participating in tournaments like NFA is the opportunity to get to know teams and individuals from throughout the nation. You have invested tremendous time and energy to arrive at this place. Make the most of it. Enjoy your time together. Put forth your best effort. Appreciate the talents of all participants.

I know from experience that you will not have a lot of “down time” during the tournament – but if you do, I hope you are able to enjoy the beauty of our campus and community. Take a stroll through Putnam Park that runs through campus, stand on the footbridge and soak in the vistas of the Chippewa River (don't be surprised if you see one of our resident Bald Eagles), or climb “The Hill” just for fun!

You may notice a display trophy case in Hibbard Hall containing some of the many trophies the UW-Eau Claire team has been fortunate enough to win over the years – including an NFA sweepstakes trophy while I was a member of the team way back in 1977.

The memories of that tournament are still vivid in my mind. Time to make your own NFA memories!

Best wishes for a fun and successful tournament.

Mike Rindo ('78)  
Assistant Chancellor for Facilities and University Relations  
University of Wisconsin-Eau Claire

*Excellence. Our measure, our motto, our goal.*

---

Office of the Chancellor • Schofield 206 (715) 836-2327 • fax: (715) 836-2902 • [www.uwec.edu](http://www.uwec.edu)

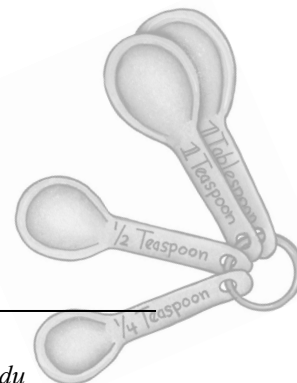

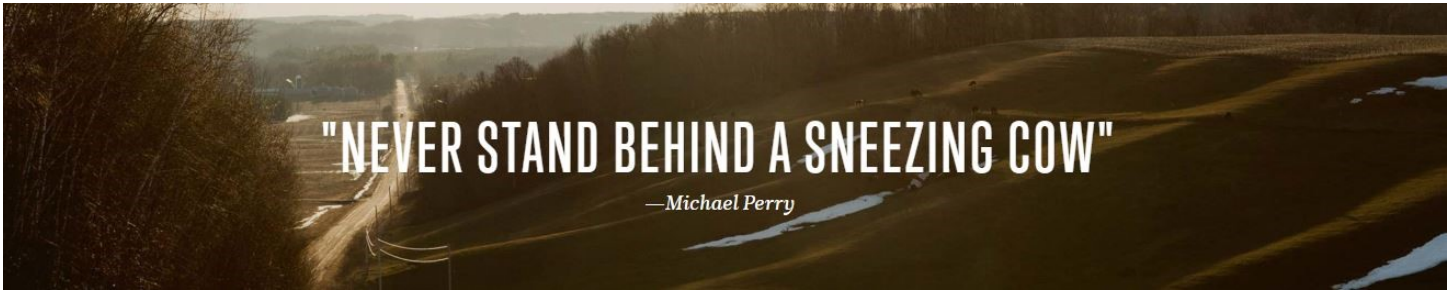

Dear NFA participants:

Welcome to the University of Wisconsin—Eau Claire for the National Forensics Association (NFA) National Championship. As a graduate of the UW—Eau Claire School of Nursing who wound up doing something completely different thanks in no small part to forensics, I hope you will enjoy your visit to the Chippewa Valley that has done so much for a country boy like me.

I especially welcome you in the name of forensics. I never achieved the level of proficiency you have demonstrated in order to earn your participation in this national competition, and as such I can only offer my humble congratulations.

On the other hand, forensics utterly and unexpectedly changed my life. Despite my background as a rural farm kid and eventually a registered nurse, I quite unexpectedly wound up making a living as a writer, speaker, and performer. How fortunate for me, then, that during my formative years I learned to present myself in public by participating in forensics (hats off to my junior high English teacher—she gave me the nudge, when all I cared about was pickup trucks and football). To this day, when I stand behind a podium, or take the stage, or head out on book tour, I am drawing on skills and opportunities developed through forensics.

I wish you well in the competition, but above all I thank you for your dedication to forensics, which in the final analysis is about personal communication in real time—a critical element in forging the connections upon which our unexpected futures rely.

Respectfully,

Michael Perry  
[www.sneezingcow.com](http://www.sneezingcow.com)





## **Non-Denominational Service:**

We will have a Non-Denominational Easter service from 7:00-7:45 AM in The Chippewa room at the Clarion Hotel. Musical talent will be provided by University of Wisconsin– Eau Claire String Players. Message by Bradley University Alumni/UWEC Coach Ryan Morris (NFA Duo Champion '98).

## **Easter Festivities:**

We are also having an Easter egg hunt all day on Sunday! We will have eggs filled with candy that will be hidden around campus for students to find. There will be a photo contest for students to participate in. You need to use the hashtag #NFAEggHunt and post pictures finding the eggs on Instagram, Facebook and Twitter. We will pick one picture from each social media site to win a \$10 Starbucks gift card. That means there are three chances to win! The more pictures you post on each social media site, the better chance you have of winning, but make sure you use the hashtag to enter! The winner will be announced on social media.



**#NFAEggHunt**



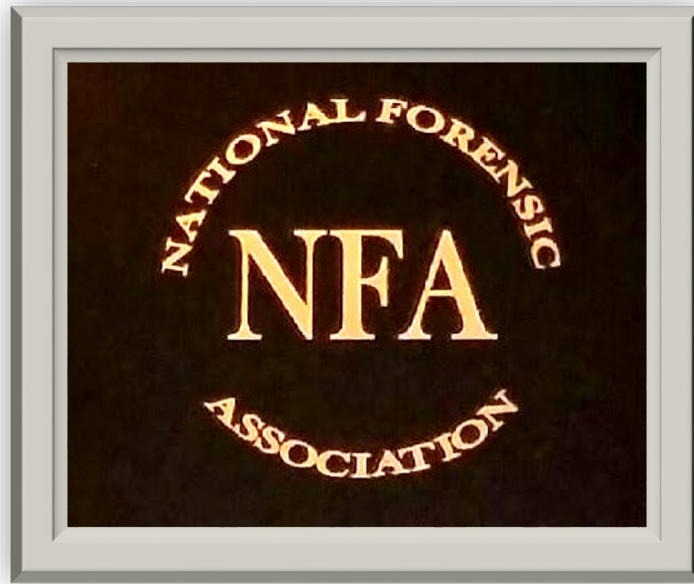

In 1971, Dr. Seth Hawkins, concluding that the needs of the forensics community warranted a National I.E. Tournament invented a national championship in individual events, declared it official by fiat and sent invitations. The tournament featured Prose, Poetry, Extemporaneous, Impromptu, After-Dinner Speaking and Oratory. The following 23 schools were in attendance: American University (DC), Ball State University (IN), Defiance College (OH), Eastern Kentucky University, Eastern Michigan University, Evangel College (MO), Georgetown College (KY), Heidelberg College (OH), University of Kentucky, Lehigh University (PA), University of Southern Maine, University of Maryland, Miami University (OH), Niagara University (NY), Ohio University, Ohio Northern University, Purdue University (IN), Sheperd University (WV), Southern Connecticut State University, St John's College (NY), St. Rose College (NY), West Chester University (PA) and Wright State University (OH).

In 1973, A draft constitution for the National Forensics Association was written in January to create a governing body for the I.E. Tournament. The constitution was accepted at the tournament in April at Eastern Michigan University

Since 1971, the growth of NFA is evidence of the Association's devoted mission of expanding and enhancing collegiate educational opportunities in speech communication nationwide. The NFA continues on in its rich traditions of excellence in the forensics competition with the help of a much devoted and dedicated team.

In the 46th edition of the NFA Tournament Book, we are proud to provide you with a continuance of traditions of excellence in forensics competition.

# Schools in Attendance

Arizona State University  
 Ball State University  
 Berry College  
 Bradley University  
 Butler University  
 California State University, Chico  
 California State University, Long Beach  
 California State University, Los Angeles  
 California State University, Sacramento  
 Cameron University  
 Capital University  
 Carson-Newman University  
 Central Michigan University  
 Concordia University, Nebraska  
 Crowder Community College  
 Eastern Illinois University  
 Eastern Michigan University  
 Fairmont State University  
 Florida State College at Jacksonville  
 Florida State University  
 Grand Canyon University  
 Hillsdale College  
 Hofstra University  
 Illinois State University  
 John Carroll University  
 Johnson County Community College  
 Lafayette College  
 Lewis & Clark College  
 Liberty University  
 Marshall University  
 McKendree University  
 Minnesota State University, Mankato  
 Missouri State University  
 Monmouth College

North Central College  
 North Dakota State University  
 Northeastern State University  
 Northern Illinois University  
 Northwestern University  
 Ohio University  
 Pacific University  
 Piedmont College  
 Rice University  
 Ripon College  
 Saint Joseph's University  
 Simpson College  
 Southeastern Oklahoma State University  
 Southern Illinois University  
 St. Anselm College  
 Sterling College  
 Tarleton State University  
 Texas A&M University  
 Texas State University  
 Texas Christian University  
 The University of Oklahoma  
 Truman State University  
 Tennessee State University  
 University of Akron  
 University of California, Berkley  
 University of Central Florida  
 University of Central Missouri  
 University of Illinois at Chicago  
 University of Illinois at Urbana-Champaign  
 University of Louisiana at Lafayette  
 University of Minnesota  
 University of Nebraska-Lincoln  
 University of North Dakota  
 University of South Dakota

University of Texas at Austin  
 University of the Pacific  
 University of Wisconsin-Eau Claire  
 University of Wisconsin-Madison  
 University of Wisconsin-Oshkosh  
 University of Wisconsin-Whitewater  
 Wayne State University  
 Western Kentucky University  
 Western Nebraska Community College  
 Wiley College  
 William Carey University



## 1970-1975

David Beal  
Greg Denaro

Jim Molnar  
Judy Sturgis-Hill  
Danny Vice  
Keith Semmel  
Paul Van Dyne

## 1976-1980

Jon Capecci  
Michael Garcia  
Theresa McElwee  
Donald Smith

Elighie Wilson  
William Allen Young  
Nancy Cartwright  
Mark Hickman  
Chris Reynolds

Kendra Ceasy Dean  
Ray Quiel  
Margaret Langford

## 1981-1985

Marco Benassi  
Greg Dolph  
Sam Marcossan  
J.G. Harrington  
Tom Doyle  
Mitchell "Bucky" Fay

Andrew Heaton

## 1986-1990

David Bickford  
Liesel Reinhart  
Sarah Braun  
Cam Jones  
Stephanie Kaplan  
Kim Roe  
Celeste Matheson  
Penny Geurink O'Connor  
Joel Schwartzberg  
Ken Klawitter  
Jeff Seasholtz  
Tom Zeidler-Adamson

Ohio University  
Southern Connecticut  
University  
Ohio University  
Eastern Michigan University  
Eastern Michigan University  
Mansfield State University  
Penn State University

Eastern Michigan University  
Eastern Michigan University  
Eastern Michigan University  
Southern Connecticut  
University  
Ball State University  
University Southern California  
Ohio University  
Marshall University  
Bowling Green State  
University/Ohio University  
Miami University  
Eastern Michigan University  
George Mason University

Bradley University  
Bradley University  
Bradley University  
Rutgers University  
Bradley University  
University of Wisconsin-  
Eau Claire  
Bradley University

Brown University  
University of Colorado  
Bradley University  
Cornell University  
University Wisconsin-Madison  
Eastern Michigan University  
Illinois State University  
University of Northern Iowa  
Emerson College  
Bradley University  
Eastern Michigan University  
Illinois State University

## 1991-1995

Jason Berke  
Rita Rahoi  
  
Michael Malloy  
Andy Wood  
Adam Black  
Karon Bowers  
George LaMaster  
Kevin Minch  
Patrick O'Shaughnessy  
Stacy Nekula  
Mona Dworzak  
Andrew Billings  
Jeff Archibald  
Amy Darnell

## 1996-2000

August Benassi  
Brian Davis  
Matt MacDonald  
Jill Valentine  
Ben Lohman  
Chris Grove  
Brendan Kelly  
David Lindrum  
Robert Pieranunzi  
Jason Davidson  
Sarah Meinen Jedd  
Jaime Riewerts  
Will Koch  
Justin Zabor  
Kelly (Lloyd) Adreani  
Ryan Hershberger  
John Boyer

## 2001-2005

Aaron Unseth  
  
John Coleman  
Robert Barnhart  
Erin Gallagher Barnhart  
Bryan McCann  
Robb Telfer  
Shannon Maney  
Matthew Collie  
  
Eric Long  
Amber (Neuenschwander)  
Price  
Nina Brennan  
Ken Young  
AJ Moorehead

## 2006-2010

Robert Cannon

Illinois State University  
University of Wisconsin-  
Eau Claire  
Saint Joseph's University  
Berry College  
Western Kentucky University  
Bradley University  
Bradley University  
Wayne State University  
Bradley University  
Illinois State University  
Illinois State University  
Indiana University  
Cornell University  
Moorehead State University

Bradley University  
Arizona State University  
Bradley University  
Bradley University  
Bradley University  
Illinois State University  
Eastern Michigan University  
Berry College  
Indiana University  
Bradley University  
Bradley University  
Bradley University  
Illinois State University  
Ohio University  
Eastern Michigan University  
Eastern Michigan University  
Otterbein College

University of Wisconsin-  
Eau Claire  
Berry College  
Ohio University  
Ohio University  
Illinois State University  
Illinois State University  
Illinois State University  
Minnesota State University -  
Mankato  
Bradley University  
Eastern Michigan University  
  
Eastern Michigan University  
Bradley University  
Arizona State University

Glendale Community College



## NFA Hosts

2017 University of Wisconsin-Eau Claire  
 2016 Ball State University  
 2015 Ohio University  
 2014 Eastern Michigan University  
 2013 Marshall University  
 2012 Ohio University  
 2011 Illinois State University  
 2010 Ohio University  
 2009 Missouri State University/Drury University  
 2008 Tennessee State University  
 2007 Berry College  
 2006 University of Wisconsin-Eau Claire  
 2005 University of Akron  
 2004 Western Illinois University  
 2003 Ball State University  
 2002 Berry College  
 2001 Western Kentucky University  
 2000 Ohio University  
 1999 Eastern Michigan University  
 1998 Western Illinois University  
 1997 Ball State University  
 1996 Western Illinois University  
 1995 Eastern Michigan University  
 1994 Western Kentucky University  
 1993 Bloomsburg State University  
 1992 Mankato State University  
 1991 Marshall University  
 1990 Mankato State University  
 1989 Upsala College (East Orange, NJ)  
 1988 Arizona State University  
 1987 Mankato State University  
 1986 Bloomsburg University  
 1985 Marshall University  
 1984 Georgia Southern University  
 1983 Illinois State University  
 1982 Ohio State University  
 1981 Western Kentucky University  
 1980 University of Montevallo  
 1979 University of Wisconsin-Whitewater  
 1978 Monmouth University  
 1977 George Mason University  
 1976 California State University-Los Angeles  
 1975 Niagra State University  
 1974 Plattsburgh State University  
 1973 Eastern Michigan University  
 1972 Ohio Northern University  
 1971 Ohio Northern University

## Larry Schnoor President's Award

2002 Eddie Meyers University of West Florida  
 2011 Dennis Beagan Eastern Michigan University  
 2015 Larry Schnoor Minnesota State University-Mankato  
 2016 Randy Richardson Berry College

## Distinguished Service Award

George Armstrong	Bradley University
I.E. Listserve	Cornell University
Margaret Greynolds	Georgetown College
Ed Harris	Suffolk University
Seth Hawkins	Southern Connecticut University
Bill Henderson	University of Northern Iowa
Vicki Karns	Suffolk University
Michael P. Kelley	California State-Los Angeles
Michael Leiboff	Mansfield State University
Al Montanaro	Plattsburgh State University
Eddie Myers	University of West Florida
Chris Reynolds	University of Wisconsin-Eau Claire/Otterbein College
Robbi Rowe	Stetson University
Larry Schnoor	Minnesota State University-Mankato
Walter Stump	University of Southern Maine
Michael Tew	Eastern Michigan University

## Eddie Meyer's Award

2004 Randy Richardson	Berry College
2005 Ray Quiel	Eastern Michigan University
2005 Harry Strine	Bloomsburg University
2006 Mark Hickman	West Chester University
2006 Ed Hinck	Central Michigan University
2006 Karen Morris	University of Wisconsin-Eau Claire
2008 Susan Milsap	Otterbein College
2008 Dan Smith	Bradley University
2008 Bruce Wickelgren	Suffolk University
2009 Richard Paine	North Central College
2009 Dave Trumble	St. Anselm's College
2011 Kelly Larson	Missouri Southern College
2013 Brendan Kelly	University of West Florida
2013 George LaMaster	Marian University
2014 Audrey Cunningham	University of Indianapolis
2015 Marty Birkholt	Creighton University
2016 Marlin Bates	University of the Pacific

## Team Champions

2016	Western Kentucky University
2015	Western Kentucky University
2014	Western Kentucky University
2013	Bradley University
2012	Bradley University
2011	Western Kentucky University
2010	Western Kentucky University
2009	Western Kentucky University
2008	Western Kentucky University
2007	Western Kentucky University
2006	Western Kentucky University
2005	Bradley University
2004	Western Kentucky University
2003	Western Kentucky University
2002	Bradley University
2001	Bradley University
2000	Illinois State University
1999	Illinois State University
1998	Bradley University
1997	Bradley University
1996	Bradley University
1995	Illinois State University
1994	Bradley University
1993	Bradley University
1992	Bradley University
1991	Bradley University
1990	Bradley University
1989	Bradley University
1988	Bradley University
1987	Eastern Michigan University
1986	Eastern Michigan University
1985	Bradley University
1984	Bradley University
1983	Bradley University
1982	Bradley University
1981	Eastern Michigan University
1980	Eastern Michigan University
1979	Eastern Michigan University
1978	Eastern Michigan University
1977	Eastern Michigan University
1976	Eastern Michigan University
1975	Ohio University
1974	Ohio University
1973	Eastern Michigan University
1972	Ball State University
1971	Ohio University

## Pentathlon Champions



2016	Farrah Bara	University of Texas at Austin
2015	Jerome Gregory	Bradley University
2014	Andrew Neylon	Ball State University
2013	Kaybee Brown	Bradley University
2012	Jacoby Cochran	Bradley University
2011	Jacoby Cochran	Bradley University
2010	Dan Glaser	Ohio University
2009	Joele Denis	Western Kentucky University
2008	Jessy Ohl	Kansas State University
2007	Kashif Powell	Morehouse College
2006	Paul Davis	Arizona State University
2005	Antonio Moorehead	Arizona State University
2004	John Coleman	Berry College
2003	Meredith Schnug	Miami University
2002	Eric Long	Bradley University
2001	Steve Zammit	Cornell University
2000	Dan Hungerman	Miami University
1999	Brian Davis	Arizona State University
1998	Grant Ward	Illinois State University
1997	Brendan Kelly	Eastern Michigan University
1997	Chris Grove	Illinois State University
1996	August Benassi	Bradley University
1995	Jason Berke	Illinois State University
1994	Andy Wood	Berry College
1993	Jason Berke	Illinois State University
1992	Ronnie Stewart	Bradley University
1991	Karon Bowers	Bradley University
1990	Stephanie Kaplan	University of Wisconsin-Madison
1989	Cam Jones	Cornell University
1988	Brenda Dempsey	Eastern Michigan University
1987	Laura Duncan	Eastern Michigan University
1986	Greg Dolph	Bradley University
1985	John Broer	Miami University
1984	Brad Johansen	Bradley University
1983	Mike Jones	Eastern Michigan University
1982	Theresa McElwee	Eastern Michigan University
1981	Jon Capecci	Eastern Michigan University
1980	Jon Capecci	Eastern Michigan University
1979	George Denger	Eastern Michigan University
1978	William Young	University of Southern California
1977	Michael Garcia	Eastern Michigan University
1976	Irene Ziegler	Stetson University
1975	Bobbi Rowe	Stetson University
1974	Bobbi Rowe	Stetson University
1973	Jim Molnar	Ohio University
1972	Jim Molnar	Ohio University
1971	Robert Reider	Ohio University



## Impromptu Speaking

2016	Jerome Gregory	Bradley University
2015	Paige Settles	Western Kentucky University
2014	Patrick Seick	Eastern Michigan University
2013	Andrew Neylon	Ball State University
2012	Joshua Hiew	Northwestern University
2011	Shira DeCovnick	Northwestern University
2010	Todd Rainey	Western Kentucky University
2009	Meredith Regan	University of Texas-Austin
2008	Jessica Furgerson	Western Kentucky University
2007	Joelle Perry	Western Kentucky University
2006	Saeed Jones	Western Kentucky University
2005	Antonio Moorehead	Arizona State University
2004	Allison Rank	Miami University
2003	Rob Barnhart	Ohio University
2002	Rob Barnhart	Ohio University
2001	Bryan McCann	Illinois State University
2000	Nathan Mather	Northwestern University
1999	Chris Kristofco	St. Joseph's University
1998	Chris Kristofco	St. Joseph's University
1997	Mike Thompson	Miami University
1996	Paul Higday	University of Pennsylvania
1995	Jeff Archibald	Cornell University
1994	Kevin Minch	Wayne State University
1993	Eric Martin	Bradley University
1992	Ronnie Stewart	Bradley University
1991	Nick Fynn	Ohio University
1990	Ed Wisnioski	Illinois State University
1989	Cam Jones	Cornell University
1988	Cam Jones	Cornell University
1987	Scott Wilson	University of Minnesota
1986	Mitchell "Bucky" Fay	University of Wisconsin- Eau Claire
1985	Michelle Patrick	LaSalle University
1984	David Alabach	Bradley University
1983	Sam Marcossou	Bradley University
1982	Tom McCarthy	Bradley University
1981	Mary Foersch	University of Virginia
1980	Justin Hughes	Oberlin College
1979	George Denger	Eastern Michigan University
1979	Dan Bernard	Eastern Michigan University
1978	William Young	University of California
1977	Butch Maltby	Wheaton College
1976	Alberto Coll	Princeton University
1975	Jan Marrow	California State University
1974	Alberto Coll	Princeton University
1973	Jerry Bluhm	Eastern Michigan University
1972	Michael Muth	Ohio University
1971	Lisa Uhrig	Ball State University

## Extemporaneous Speaking <sup>15</sup>

2016	Farrah Bara	University of Texas-Austin
2015	Farrah Bara	University of Texas-Austin
2014	Carolyn Evans	Western Kentucky University
2013	Alexis Elliott	Western Kentucky University
2012	Joshua Hiew	Northwestern University
2011	Joshua Hiew	Northwestern University
2010	Seth Peckham	Western Kentucky University
2009	Austin Wright	University of Texas-Austin
2008	Merry Regan	University of Texas-Austin
2007	Jill Collum	University of Texas-Austin
2006	Liz Coleman	New York University
2005	John Geibel	St. Joseph's University
2004	Michael Chen	Seton Hall University
2003	Jason Warren	Northwestern University
2002	Rob Barnhart	Ohio University
2001	Matt Ross	Ohio State University
2000	Greg Lipper	Northwestern University
1999	Chris Kristofco	St. Joseph's University
1998	Colin O'Brien	Ohio State University
1997	Brian Cooper	University of Colorado- Boulder
1996	Ted Scutti	University of Southern Colorado
1995	Paul Higday	University of Pennsylvania
1994	Tom Costigan	Illinois State University
1993	Patrick O'Shaughnessy	Bradley University
1992	Patrick O'Shaughnessy	Bradley University
1991	Nick Fynn	Ohio University
1990	Kimberly Fisher	Arizona State University
1989	Mike Jacoby	Bradley University
1988	Mike Jacoby	Bradley University
1987	David Bickford	Brown University
1986	David Bickford	Brown University
1985	David Bickford	Brown University
1984	Michael Paton	Ohio State University
1983	Roger Aden	Nebraska-Lincoln
1982	Kate Joeckel	Nebraska-Lincoln
1981	Andy Heaton	Bradley University
1980	Sean Aiken	St. Olaf College
1979	George Denger	Eastern Michigan University
1978	Steve Walton	Kansas State University
1977	Butch Maltby	Wheaton College
1976	Kevin Brady	Princeton University
1975	Don Rice	Ohio University
1974	Alberto Coll	Princeton University
1973	Jerry Bluhm	Eastern Michigan University
1972	Fred Schmidt	Georgetown University
1971	Rob Frazier	Lehigh University



## Poetry Interpretation

2016	Abigail Onwunali	University of Texas-Austin
2015	Sebastian Orozco	Western Kentucky University
2014	Lindsey White	Western Kentucky University
2013	Tyler Rife	Western Kentucky University
2012	Cecil Blutchter	Bradley University
2011	Chelsea Harman	Western Kentucky University
2010	Dan Glaser	Ohio University
2009	Joele Denis	Western Kentucky University
2008	Clarence Ball	Tennessee State University
2007	Kashif Powell	Morehouse University
2006	Paul Davis	Arizona State University
2005	Antonio Moorehead	Arizona State University
2004	David Montgomerie	Illinois State University
2003	Antonio Moorehead	Arizona State University
2002	Joshua Green	Miami University
2001	Joshua Green	Miami University
2000	Khadeejah Johnson	Arizona State University
1999	Robert Milz	Northern Arizona University
1998	Heidi Sulzman	Arizona State University
1997	Latonya Mason	Eastern Michigan University
1996	Kevin Rolston	St. Joseph's University
1995	Heidi Sulzman	Arizona State University
1994	David Kneebone	Indiana University
1993	Michael Malloy	St. Joseph's University
1992	Antoine McKay	Eastern Michigan University
1991	William Coelius	Eastern Michigan University
1990	Sarah Braun	Bradley University
1989	Sarah Braun	Bradley University
1988	Liesel Reinhart	University of Colorado
1987	Laura Duncan	Eastern Michigan University
1986	Kathy Kasdorf	Illinois State University
1985	Greg Dolph	Bradley University
1984	Lisa Philips	Ohio State University
1983	John Allen	Illinois State University
1982	Cindy Rieke	Illinois State University
1981	Carolyn Mungo	Bradley University
1980	Laura Gordon	Clarion University
1979	Pam Wallace	Eastern Michigan University
1978	William Young	University of Southern California
1977	Michael Garcia	Eastern Michigan University
1976	Sandra Tett	Northern Michigan University
1975	Mary Stout	Marshall University
1974	Darrell Pope	Heidelberg College
1973	Michelle Morris	University of Montevallo
1972	David Beal	Ohio University
1971	Jim Molnar	Ohio University

## Prose Interpretation

2016	Abigail Onwunali	University of Texas-Austin
2015	Karen Bagoumian	Eastern Michigan University
2014	Elle Pratt	Western Kentucky University
2013	Brooke Stevenson	Bradley University
2012	Camille Yameen	Bradley University
2011	Jasmine McLeod	California State-Long Beach
2010	Chris Fowler	Creighton University
2009	Amanda Samoyloff	California State-Long Beach
2008	Adam Sharples	Bradley University
2007	Chris Griesinger	Eastern Michigan University
2006	Lacy Lowrey	Bradley University
2005	Scott Pyle	Bradley University
2004	Jacob Hodgson	Eastern Michigan University
2003	Mike Slefinger	Illinois State University
2002	Joshua Green	Miami University
2001	Joe O'Brien	St. Joseph's University
2000	Robert Pieranunzi	Indiana University
1999	Robert Pieranunzi	Indiana University
1998	Jill McCall	Bradley University
1997	Heidi Sulzman	Arizona State University
1996	James Dobson	Northern Arizona University
1995	Ed Reed	Bradley University
1994	Laial Dahr	Eastern Michigan University
1993	Jason Davidson	Bradley University
1992	William Coelius	Eastern Michigan University
1991	Amy Olsen	Bradley University
1990	Jean Lamarra	Brooklyn College
1989	Robert Adanto	Arizona State University
1988	Todd Tesen	Eastern Michigan University
1987	Debbie Belskie	Ohio State University
1986	Greg Dolph	Bradley University
1985	Tony Maull	George Mason University
1984	Tim Clue	Bradley University
1983	Bobbye Perrin	Eastern Michigan University
1982	Cindy Reike	Illinois State University
1981	Roland Spies	Illinois State University
1980	Morty Ross	Clark College
1979	Michael Garcia	Eastern Michigan University
1978	Mark Ferguson	Bowling Green University
1977	Michael Garcia	Eastern Michigan University
1976	Roscoe C. Burkes	Northern Illinois University
1975	Carol Pounder	Ithaca University
1974	Judy Blackwell	Albion College
1973	Darrell Pope	Heidelberg College
1972	Jim Molnar	Ohio University
1971	Jim Molnar	Ohio University



# Persuasive Speaking

# Informative Speaking



2016	Farrah Bara	University of Texas-Austin
2015	Sydney Machesky	Wayne State University
2014	Nick Gilyard	Western Kentucky
2013	Jacoby Cochran	Bradley University
2012	William Igbokwe	University of Texas-Austin
2011	Jacoby Cochran	Bradley University
2010	Patrick Campbell	Bradley University
2009	Austin Wright	University of Texas-Austin
2008	Jessy Ohl	Kansas State University
2007	Chris Griesinger	Eastern Michigan University
2006	Chris Brasfield	Western Kentucky University
2005	Jonathan Carter	Northwestern University
2004	Kelly Bender	University of Wisconsin-Eau Claire
2003	Ben Schneider	University of Wisconsin-Eau Claire
2002	Chris Lahna	Miami University
2001	Steve Zammit	Cornell University
2000	Dan Hungerman	Miami University
1999	Amanda Hickman	Miami University
1998	Christine Smith	Bradley University
1997	Chris Grove	Illinois State University
1996	Shawn Harris	University of Wisconsin-Eau Claire
1995	Jayme Wilson	Eastern Michigan University
1994	Andy Wood	Berry College
1993	George LaMaster	Bradley University
1992	Todd Prins	University of Northern Iowa
1991	Athena Papachronis	Bradley University
1990	Stephanie Kaplan	University of Wisconsin-Madison
1989	Betsy Hefferman	University of Wisconsin-Madison
1988	Brenda Dempsey	Eastern Michigan University
1987	Jan Moreland	Illinois State University
1986	Kay Hriensaitong	Bradley University
1985	John Broer	Miami University
1984	Inta Lulis	George Mason University
1983	Michael Jones	Eastern Michigan University
1982	Dennis Upah	Bradley University
1981	Annemarie Mungo	Eastern Michigan University
1980	Sean O'Rourke	Humboldt State
1979	George Denger	Eastern Michigan University
1978	John Rodden	LaSalle University
1977	Ruth Brenner	University of Wisconsin-Eau Claire
1976	Mohammad	Los Angeles Valley College
1975	Sue Sciamé	Ball State University
1974	Joe Matthews	Defiance College
1973	Barry Ybrra	California Lutheran
1972	Mark Graff	Ohio Northern University
1971	Ruth Brisbain	Defiance College

2016	Kevin King	University of Texas-Austin
2015	Kevin King	University of Texas-Austin
2014	Adam Rayzor	Bradley University
2013	Ryan Tinlin	Bradley University
2012	Tyler Dailey	Western Kentucky University
2011	Blake Longfellow	Bradley University
2010	Dillon White	Northwestern University
2009	Robert Cannon	Glendale Community College
2008	Jessy Ohl	Kansas State University
2007	Kashif Powell	Morehouse College
2006	Kyle Schultz	Illinois State University
2005	Lydia Nelson	Western Kentucky University
2004	Caleb Williams	Western Kentucky University
2003	Annalisa Esposito	Eastern Michigan University
2002	Meredith Schnug	Miami University
2001	Martin Note	Bradley University
2000	Will Koch	Illinois State University
1999	Will Major	Illinois State University
1998	Ann Hackel	University of Wisconsin-Eau Claire
1997	Ryan Hershberger	Eastern Michigan University
1996	Mona Dworsack	Illinois State University
1995	Bob Moore	Illinois State University
1994	Ed Reed	Bradley University
1993	Ed Reed	Bradley University
1992	Brian Gardner	Morehead State University
1991	Tony Brooks	Bradley University
1990	Stephanie Kaplan	University of Wisconsin-Madison
1989	Joey Callow	Miami University
1988	Brenda Dempsey	Eastern Michigan University
1987	Theresa Buescher	Illinois State University
1986	Brian Welch	Bradley University
1985	Brenda Dempsey	Eastern Michigan University
1984	Bobbye Perrin	Eastern Michigan University
1983	Rachel Holloway	Morehead State University
1982	Rachel Holloway	Morehead State University
1981	Jon Capecci	Eastern Michigan University
1980	Kenda Creasy	Miami University
1979	Christina Reynolds	Ohio University
1978	William Young	University of California
1977	Michael Garcia	Eastern Michigan University
1976	Irene Ziegler	Stetson University
1975	Joey Golden	Eastern Michigan University
1974	Giselle Quijley	West Chester University



## After Dinner Speaking

2016	Sami White	Eastern Michigan University
2015	Berkley Conner	Ball State University
2014	Patrick Seick	Eastern Michigan University
2013	Brooke Stevenson	Bradley University
2012	Ryan Cashman	Illinois State University
2011	Ryan Cashman	Illinois State University
2010	Joe Cozza	Illinois State University
2009	Michael Norris	Illinois State University
2008	Emily Hopper	University of Alabama
2007	Chris Griesinger	Eastern Michigan University
2006	Annie Kincade	Illinois State University
2005	Richard Yu	Clemson University
2004	Shannon Maney	Illinois State University
2003	Robb Telfer	Illinois State University
2002	Robb Telfer	Illinois State University
2001	Kami Kosenko	Bradley University
2000	Amber Price	Eastern Michigan University
1999	Dana Lovecchio	Bradley University
1998	Brendan Kelly	Eastern Michigan University
1997	David Lindrum	Berry College
1996	Ben Lohman	Bradley University
1995	Leigh Stickler	Indiana University
1994	Calvin Fong	Bradley University
1993	Trace Milan	Arizona State University
1992	Steve Futterman	Miami University
1991	Jeff Seaholtz	Eastern Michigan University
1990	Joel Schwartzberg	Emerson College
1989	Jeff Sculley	Bradley University
1988	Kim Roe	Eastern Michigan University
1987	Kim Roe	Eastern Michigan University
1986	Kim Roe	Eastern Michigan University
1985	Melissa Dean	Miami University
1984	Tim Muelhoff	Eastern Michigan University
1983	Martha Ford	Ohio State University
1982	Mike Bailey	Eastern Michigan University
1981	Jon Capecci	Eastern Michigan University
1980	Jon Capecci	Eastern Michigan University
1979	Ric Roe	Ohio State University
1978	Connie Day	Marshall University
1977	Jerry Neil	University of Tennessee
1976	Mark Hickman	Glenville State University
1975	Randy Miller	Elizabethtown University
1974	Darryl Dean	Eastern Michigan University
1973	David Beal	Ohio University
1972	Judy Sturgis	Eastern Michigan University
1971	Cathie Craig	Georgetown College

## Rhetorical Criticism

2016	Bri Kirkham	Ball State University
2015	Jerome Gregory	Bradley University
2014	Andrew Neylon	Ball State University
2013	Jacoby Cochran	Bradley University
2012	Jacoby Cochran	Bradley University
2011	Liz Miller	Miami University
2010	James McGraw	St. Joseph's University
2009	Dan Glaser	Ohio University
2008	Jessy Ohl	Kansas State University
2007	Kashif Powel	Morehouse College
2006	Collin McDonnell	Bradley University
2005	Brandon Wood	Illinois State University
2004	Antonio Moorehead	Arizona State University
2003	Meredith Schnug	Miami University
2002	Chris Lahna	Miami University
2001	Chris Lahna	Miami University
2000	Dan Hungerman	Miami University
1999	Amanda Hickman	Miami University
1998	Kristen Saponaro	St. Joseph's University
1997	Heather Blair	Ohio State University
1996	Jayne Wilson	Eastern Michigan University
1995	Jason Berke	Illinois State University
1994	Danielle Rogowski	Oakland University
1993	Robin Silbergleid	Illinois State University
1992	Ronnie Stewart	Bradley University
1991	Karon Bowers	Bradley University
1990	Stephanie Kaplan	University of Wisconsin-Madison
1989	Stephanie Kaplan	University of Wisconsin-Madison
1988	John Welk	North Central College
1987	Michael Stotts	University of Wisconsin-Madison
1986	Jim McCafferty	George Mason University
1985	Tracy Anderson	Bradley University
1984	Steve Sudhoff	Bradley University
1983	Sam Marcossan	Bradley University
1982	Brian Marsh	Illinois State University
1981	Denise Bostdorff	Bowling Green University
1980	Kathy Fig	Moorhead State University
1979	Eileen Scallen	St. Olaf College
1978	Ray Quiel	Eastern Michigan University
1977	Christine Neiditch	George Mason University
1976	Stephen Collie	Illinois State University
1975	Dot Freeman	Ball State University

## Duo Interpretation

2016	Alexa Thomas/ Lizzette Marrero	University of Texas - Austin
2015	Huy Pham/Berkley Conner	Ball State University
2014	Nick Gilyard/Ray Roberts	Western Kentucky University
2013	Robi Mahan/Mike Tristano	Illinois State University
2012	Jeremy Frazer/Nadine Ajaka	Ohio University
2011	Ethan Millsbaugh/ Chelsea Harman	Western Kentucky University
2010	Brian Gaston/Angelica Davis	University of Texas Austin
2009	Cornelius Lee/Ashley Litsey	Western Kentucky University
2008	Emambu Atabong/ Elijah Misigaro	Bradley University
2007	Katelyn Wood/Annie Kincade	Illinois State University
2006	Natalie Sintek/Lydia Nelson	Western Kentucky University
2005	Tyler Billman/Lacy Lowrey	Bradley University
2004	Michael Marion/Nina Brennan	Eastern Michigan University
2003	Joshua Green/Leah Wessman	Miami University
2002	Jaime Riewerts/Joseph Raab	Bradley University
2001	Zachary Dempsey/Alex Paez	San Francisco State
2000	Elizabeth Kenny/ Robert Pieranunzi	Indiana University
1999	Romel Jamison/Nelson Ellis	Illinois State University
1998	Rob Allen/Ryan Morris	Bradley University
1997	Chad Olsen/Heidi Sulzman	Arizona State University
1996	Chris Fleming/Adam Black	Western Kentucky University
1995	Lamont Vaughn/Jason Berke	Illinois State University
1994	Lori Funk/Ken Volpp	Bradley University
1993	Karl Holman/Michael Malloy	St. Joseph's University
1992	Stacy Nekula/Jodi Parks	Illinois State University
1991	Jeff Seasholtz/David Smith	Eastern Michigan University
1990	Carolyn West/William Colieus	Eastern Michigan University
1989	Sarah Braun/Jim Farruggio	Bradley University
1988	Kevin Spengel/Chris Mancini	Bradley University
1987	Ken Klawitter/Jim Skeffington	Bradley University
1986	Kevin Spengel/Greg Dolph	Bradley University
1985	Lisa Alexander/Greg Dolph	Bradley University
1984	Wally Gibson/Jim Wineburner	Bradley University
1983	Mike Jones/Darrel Copp	Eastern Michigan University
1982	Michael Bailey/ Theresa McElwee	Eastern Michigan University
1981	Michael Bailey/Maureen Berke	Eastern Michigan University
1980	John Capecci/ Theresa McElwee	Eastern Michigan University
1979	Maureen McDonough/ Theresa McElwee	Eastern Michigan University
1978	Cynthia Meier/Michael Garcia	Eastern Michigan University
1977	Gary LaParl/Mark Hickman	Marshall University
1976	Stuart/Mallet	Morehouse College
1975	Krohn/Stephen	Ohio University
1974	Kendig/Beal	Ohio University
1973	Bohannon/Deborah	University of Southern Maine
1972	Tony Trimble/Don Meade	Eastern Kentucky University

## Dramatic Interpretation <sup>19</sup>

2016	Abigail Onwunali	University of Texas-Austin
2015	Huy Pham	Ball State University
2014	Austin Groves	Western Kentucky University
2013	Ben Davis	North Central College
2012	Jasmine McLeod	California State-Long Beach
2011	Elle Pratt	Bradley University
2010	Jerome Davis	Western Kentucky University
2009	Vanessa Carranza	Bradley University
2008	Emambu Atabong	Bradley University

## Lincoln Douglas

2016	Alex Glanzman	Kansas City Community College
2015	Nefertiti Dukes	Western Kentucky University
2014	Spencer Orłowski	Western Kentucky University
2013	Susan Taylor	Western Kentucky University
2012	Alison Stickland	Drury University
2011	Sarah Spiker	Western Kentucky University
2010	Kaleb Jessee	Western Kentucky University
2009	Mike Storey	Creighton University
2006	Nick Dudley	University of Missouri
2005	Nick Dudley	University of Missouri
2004	John Henderson	Creighton University
2003	Jeremy Hollingshead	Missouri Southern University
2002	Lindsay Marquardt	University of Pennsylvania
2001	Colleen Karpinsky	St. Anselm College
2000	Sean Williams	Central Missouri State
1999	Mike McDonner	Western Kentucky University
1998	Mike McDonner	Western Kentucky University
1997	Scott Smith	Ohio State University
1996	Robert Mattingly	Western Kentucky University
1995	Mary Cunningham	Suffolk University
1994	Paul Higday	University of Pennsylvania
1993	Robert Mattingly	Western Kentucky University
1992	Cindy Weisenbeck	University of Wisconsin- Eau Claire
1991	Kevin Minch	Wayne State University

## Experimental Events

2012	<b>Forensic Criticism</b> Jeremy Johnson	Ripon College
2011	<b>Editorial Impromptu</b> Joshua Hiew	Northwestern University
2009	<b>Editorial Impromptu</b> Stan Polit	Northwestern University
2008	<b>Biographical Info</b> Stan Polit	Northwestern University
2007	<b>Orig. Shakespeare</b> Paul Gilleland	University of Wisconsin-Eau Claire
1999	<b>Dialogue Interpretation</b> Jill Valentine	Bradley University
1996	<b>Argumentative Interpretation</b> August Benassi	Bradley University

*From the Home of Eau Claire*

## Welcome to Our Home Restaurants

### Hometown Favorites-

Nucleus—Beware of the long wait for food and to be seated.  
Milwaukee Burger—Best Cheese curds in town :)

#### **Acoustic Cafe** **Lunch + Dinner**

Hours: M-Th: 7:30am–10pm F: 7:30am–11pm  
Sa: 9:30am–11pm Su: 9:30am–10pm  
715-832-9090  
505 S. Barstow Street

#### **El Patio** **Lunch + Dinner**

Hours: M-T: 11am-10pm, W-Sa: 11am-3:30am, Sunday: 12am-9pm  
715-855-8590  
408 Water St

#### **Dooley's** **Lunch + Dinner**

Hours: M-S: 11:00 AM – 2:00 am  
715-834-2388  
422 Water Street

#### **Mancinos** **Lunch + Dinner**

Hours: M-Th: 10:30am - 9pm F-Sa: 10:30-10pm Su: 10:30-8pm  
715-835-4100  
809 W. Clairemont Ave

#### **Mona Lisa's** **Dinner**

Hours: T-Th: 4pm- 11pm F:- Sa: 4pm - 12am  
715-839-8969  
428 Water St

#### **The Livery** **Lunch + Dinner**

Hours: T: 11am-11pm W/Th: 11am –12am F/S: 11am-2am  
715-833-7666  
316 Wisconsin St.

#### **Milwaukee Burger** **Lunch + Dinner**

Hours: S-TH: 11am-11pm, F/S: 11am-12am  
715-834-6503  
2620 East Clairemont Ave

#### **The Nucleus** **Breakfast + Lunch**

Hours: W-Su: 8am-2pm  
715-834-7777  
405 Water St

#### **Randy's Family Restaurant** **Breakfast + Lunch + Dinner**

Hours: M-Th: 6am - 9pm F: 6am-10pm, Sa: 6am-9pm  
715-839-8449  
1132 W MacArthur Ave.

#### **Bug Eyed Betty's** **Lunch + Dinner**

Hours: M-Sa: 11am-12am, Sun 11am-11pm  
715-514-2505  
1920 S Hastings Way

## Churches

#### **Grace Lutheran Church**

Lutheran Church  
202 W. Grand Ave.  
Eau Claire, WI 54703  
Service: Sunday 10 AM

#### **Islamic Center and Mosque**

Muslim Mosque  
527 2nd St. W.  
Altoona, WI 54720  
Service:  
Friday 1:15 PM Jummuah  
Daily 6AM Fajr Prayer  
Daily 9:15 PM Isha Prayer

#### **Jacob's Well Church**

Non-Denominational Church  
3211 N. 50th Ave.  
Chippewa Falls WI 54702  
Service: Saturday 5 PM  
Sun 9 AM & 10:45 AM

#### **Newman**

Catholic Church  
110 Garfield Ave.  
Eau Claire, WI 54701  
Service: Saturday 8 PM  
Sun 9:30 AM & 11:30 AM

#### **Temple Sholom Synagogue**

Jewish Synagogue  
1223 Emery St.  
Eau Claire, WI 54701  
Service:  
Saturday 9:30 AM Minyan Katan  
Saturday 10 AM Shacharit Service  
Saturday 11 AM Torah Service

#### **Valleybrook Church**

Baptist Church  
412 S. Barstow St.  
Eau Clare, WI 54701  
Service: Sunday 10 AM



## Campus Dining

	Wednesday	Thursday	Friday	Saturday	Sunday	Monday
	4/12/2017	4/13/2017	4/14/2017	4/15/2017	4/16/2017	4/17/2017
<b>Davies:</b>						
The Cabin	8 am - 10 pm	8 am - 10 pm	8 am - 5 pm	9 am - 4 pm	Closed	8 am - 10 pm
Marketplace	7 am - 7 pm	7 am - 7 pm	7 am - 6 pm	9 am - 5 pm	9 am - 5 pm	7 am - 7 pm
D'Italia	10 am - 7 pm	10 am - 7 pm	10 am - 4 pm	11 am - 2 pm	11 am - 2 pm	10 am - 7 pm
Blu Flame Grill	10 am - 7 pm	10 am - 7 pm	10 am - 8 pm	9 am - 5 pm	9 am - 5 pm	10 am - 7 pm
Mongolian Grill	10 am - 7 pm	10 am - 7 pm	10 am - 4 pm	11 am - 2 pm	11 am - 2 pm	10 am - 7 pm
The Skillet	7 am -2 pm	7 am -2 pm	7 am -2 pm	Closed	Closed	7 am -2 pm
Erbert's & Gerberts Bistro	10 am - 7 pm	10 am - 7 pm	10 am - 6 pm	11 am - 5 pm	11 am - 5 pm	10 am - 7 pm
Sushi Do	10 am - 6 pm	10 am - 6 pm	10 am - 4 pm	Closed	Closed	10 am - 6 pm
Snack Shack	8:30 am - 4 pm	8:30 am - 4 pm	8:30 am - 3 pm	9 am - 2 pm	9 am - 2 pm	8:30 am - 4 pm
<b>Centennial:</b>						
Einstein Bros Bagels	7:30 am - 5 pm	7:30 am - 5 pm	7:30 am - 4 pm	7 am - 4 pm	7 am - 3 pm	7:30 am - 5 pm

- ◆ **The Cabin:** Caribou brewed coffee, bakery goods, and adult beverages.
- ◆ **Marketplace:** umbrella of the food court in Davies. It hosts D'Italia, Blu Flame Grill, Mongolian Grill, The Skillet, and Erbert's & Gerbert's Bistro.
- ◆ **D'Italia:** serves a range of pasta and pizza.
- ◆ **Blu Flame Grill:** Serves your classic hamburgers, fries, cheese curds, chicken strips, and more.
- ◆ **Mongolian Grill:** Make your own stir-fry.
- ◆ **The Skillet:** Breakfast served all day!
- ◆ **Erbert's & Gerberts Bistro:** Sub sandwiches and soups.
- ◆ **Sushi Do:** serves sushi, and chicken bowls.
- ◆ **Snack Shack:** Davies little grocery store!

**Einstein Bros Bagels:**  
 Located in Centennial—  
 serves an array bagels,  
 coffee, and more!

## Special Thanks

### *For Donations:*

- ◆ Black Book Depot
- ◆ Chippewa Valley Sporting Goods
- ◆ Dunkin Donuts
- ◆ Eau Claire Mancino's Grinders & Pizza
- ◆ Ellsworth Cheese
- ◆ Mid America Forensics League
- ◆ Toppers Pizza
- ◆ University of Wisconsin— Eau Claire Forensics Team
- ◆ University of Wisconsin— Eau Claire Printing Services
- ◆ Volume One
- ◆ Zebro Realty

### *For Support:*

- ◆ AJ Moen— Event Production Supervisor
- ◆ Brian Heller—University Conference Coordinator
- ◆ Chris Hendricks—Event Services Conference Coordinator
- ◆ CJ 351 class
- ◆ Integrated Marketing Communications for equipment
- ◆ Issac Risseeuw— UWEC IMC Community Manager
- ◆ Karen Morris- CJ 351 Professor, NFA President
- ◆ Kelly Jo Wright—CJ Senior Lecturer
- ◆ Robert Mattison— IS Tech Services Senior
- ◆ Terri Knutson—Catering Director For Blugold Dining



**VISITOR PARKING**  
Permits are required Monday through Friday in all university parking lots. Visitors may stop at the Visitor Center to obtain a permit. For more information, visit the Parking and Transportation website at [www.uwec.edu/parking](http://www.uwec.edu/parking) or call 715-836-2002.

**REMINDER—**  
**UWEC IS A**  
**NON-SMOKING**  
**CAMPUS**  
Except for in locations denoted with S on the map above.

University of Wisconsin Eau Claire

© 2014 University Publications, University of Wisconsin-Eau Claire-Rev. OCT., 2014

<b>Buildings</b>	Academic Building	University Center
Administration Building	Residence Hall	Non-Public Building
<b>Parking</b>	Moped (M)	Motorcycle (C)
Faculty/Staff (F)	Bollinger Lot (B)	Recreation Lot (E) NEW
Student (S)	Public Meter (P)	
Guaranteed Faculty/Staff (G)	Residence Hall/Student (R)	

**DISABILITY** parking is available in all lots.

### Parking on Campus

- Visitors and Participants need a parking pass to park in Water Street Lot and HSS Lot.
- May Park in any spaces labeled “F” or “S.”
- DO NOT PARK IN SPACES LABELED “GF”
- Parking in Davies Lot and Hibbard Lot is FREE on Weekends.
- First Come, First Serve.
- Handicap Parking— must have BOTH (HSS/Water) Visitor permit and ADA Handicap tag displayed.

### To Water Street Lot:

1. Continue on State St.
2. Turn left on Summit Ave.
3. Continue across the bridge
4. Water Street Lot is located on the right corner of First Ave and Water Street

### To Human Sciences and Services (HSS) Lot

1. Continue on State St.
2. Turn left on Summit Ave.
3. Continue across the bridge
4. HSS Lot is located on the left corner of Second Ave. and Water St.

### LEGEND:

- Davies Student Center: **DSC**
- Schneider Hall: **SSS**
- Phillips Hall: **P**
- Centennial Hall: **Cen**
- Nursing: **N**
- Hibbard Humanities Hall: **HHH**
- Schofield Hall: **SCH**
- Old Library: **OL**
- Zorn Arena: **Zorn**
- Smoking Areas: **S**

### Across the Bridge

- Haas Fine Arts: **HFA**
- Human Science and Service: **HSS**

### To Campus From Clairemont Ave. (HWY 12)

1. Turn onto Patton St.
2. Immediately turn right onto E. Lexington Blvd.
3. Turn right onto State St.
4. Turn left on Garfield Ave. to enter campus

**Printing Services**  
Location: 1st Floor - Davies  
Thu 8:00 a.m. - 6:00 p.m.  
Fri 8:00 a.m. - 4:30 p.m.  
Sat CLOSED  
Sun CLOSED  
Mon 8:00 a.m. - 5:00 p.m.

# Davies Map

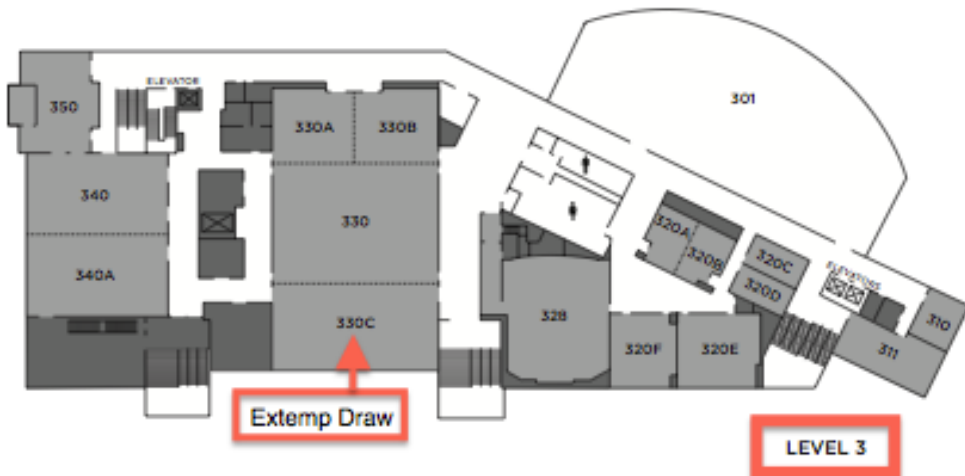

**LEVEL 3**

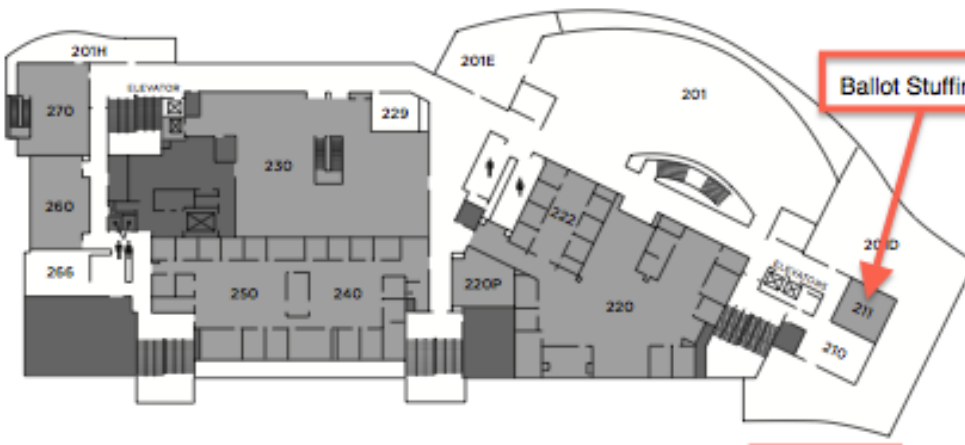

**LEVEL 2**

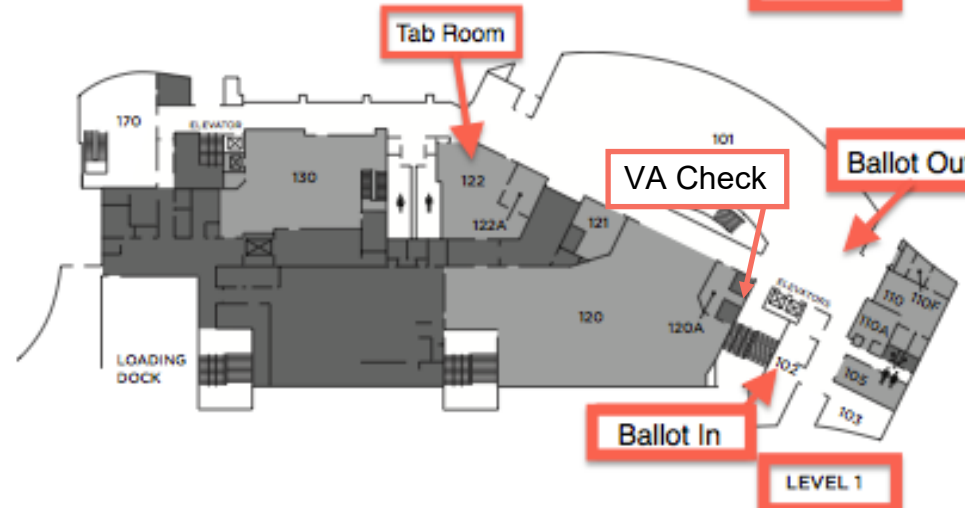

**LEVEL 1**

<b>DINING</b>	Dulany Inn .....	122
	Green Bean .....	105
	Heritage .....	122A
	Dining Retail .....	120A
	Marketplace .....	120
	Blu Flame Grill	
	D'Italia	
	Erbert and Gerbert's Bistro	
	Mongolian Grill	
	The Skillet	
Soup & Salad		
Intermezzos Café .....	121	
<b>MEETINGS + PROGRAMS</b>	Alumni .....	350
	The Cabin .....	170 + 270
	Centennial .....	320
	Centennial A .....	320A
	Centennial B .....	320B
	Chancellors .....	311
	Council Oak .....	260
	Dakota Ballroom .....	340
	Dakota .....	340
	Dakota A .....	340A
	Ho-Chunk .....	320E
	Little Niagara .....	211
	Menominee .....	320F
	Mohican .....	310
	Ojibwe Ballroom .....	330
Ojibwe .....	330	
Ojibwe A .....	330A	
Ojibwe B .....	330B	
Ojibwe C .....	330C	
Oneida .....	320D	
Potawatomi .....	320C	
Woodland Theater .....	328	
<b>SERVICES</b>	University Bookstore .....	130
	Instructional Resource	
	Rental Department .....	230
	Service Center .....	110A
	Bank .....	110F
Blugold Card Services .....	110	
<b>LOUNGES</b>	Blugold Living Room .....	201
	Dining .....	101
	Lounge .....	229
	Maple .....	102 + 103
	Media Lounge .....	210
	Oasis .....	266
	Terrace .. 201D + 201E + 201H + 301	
<b>OFFICES</b>	Administration .....	240
	Blugold Dining .....	250
	Event Services .....	240
	Student Organizations and Leadership Center .....	220
	Activities, Involvement and Leadership .....	222
	Student Organizations .....	220
	Student Senate .....	220
	Workshop .....	220P

**Important Rooms To Remember:**

- Tab Room:** 1st Floor of Davies, Dulany Inn (Rm 122)
- Ballot In Table:** 1st Floor of Davies, Maple Lounge (Rm. 102)
- Ballot Out Table:** 1st Floor of Davies, Entrance
- Visual Aid Check:** 1st Floor of Davies, Stairwell Cove
- T-Shirts and More:** 1st Floor of Davies, Maple Lounge (Rm. 103)
- Ballot Stuffing:** 2nd Floor of Davies, Little Niagara (Rm. 211)
- Extemp Prep Room:** 3rd Floor of Davies, Ojibwe C

**UWEC Bookstore**  
 Location: 1st Floor - Davies  
 Thu 7:30 a.m. - 6:00 p.m.  
 Fri 7:30 a.m. - 4:30 p.m.  
 Sat 11:00 am - 3:00pm  
 Sun CLOSED  
 Mon 7:30am - 6:00pm

*“Home Is NFA.”*

